

MINI-SA2

STANDALONE EM RFID READER



FEATURES

- Input Voltage: 12-24 VDC; 15-24 VAC;
- Current consumption: 60 mA at 12 VDC; 30 mA at 24 VDC
- Output: 1 relay (0.5A/125 VAC; 1A/30 VDC)
Latch or Pulse mode
(01 to 250 seconds)
- Read Range: up to 8cm
- Users: 4000
- Exit Button Input: Yes
- Programming cards: 1 Master Card and 1 Delete Card
- Visible LED Signal: 3 LEDs
- Audible Signal: One internal Buzzer
- Operating Temperature: -20°C to 50°C
- Protection Standard: IP66
- Resin potted electronics: Yes
- Dipswitch: For enrollment of Master and Delete Card
- Tamper switch: For higher security
- Dimension (mm): 90L x 51W x 17H
- Cable length: 50 cm

ENROL A USER

INPUT	INDICATION
1. Present Master Card	● ○ ○ short + long beep
2. Present Shadow Card	○ ● ○ short + 3 short beeps
3. Present User Card (or multiple User Cards)	○ ◐ ○ OK beep
4. Present Master Card	○ ○ ○ short + 5 short beeps

DIMENSIONS

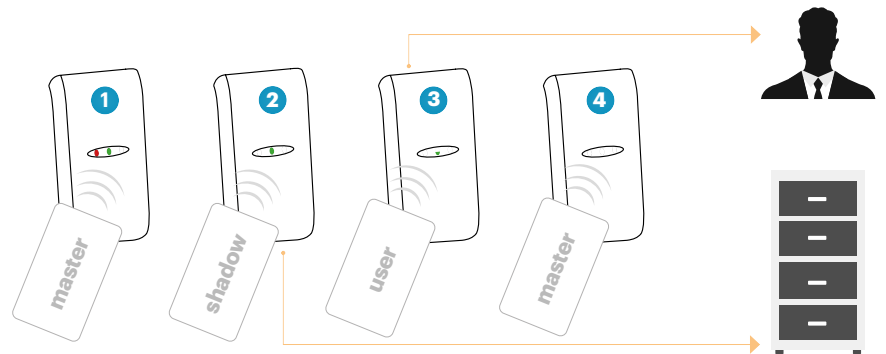
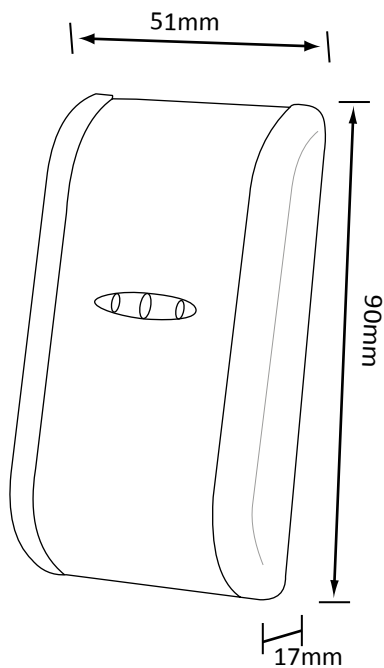

ACCESSORIES

Fobs & Cards



Ref.	PBX-1E	PBX-1C	PBX-2	PBX-2C
Features	ABS Keyfob EM4100	Leather Keyfob EM4100	0,75mm ISO Card - EM4100	2mm NISO Card - EM4100